

DONALD WALKER RELATED ITEMS AT LIBRARY OF CONGRESS

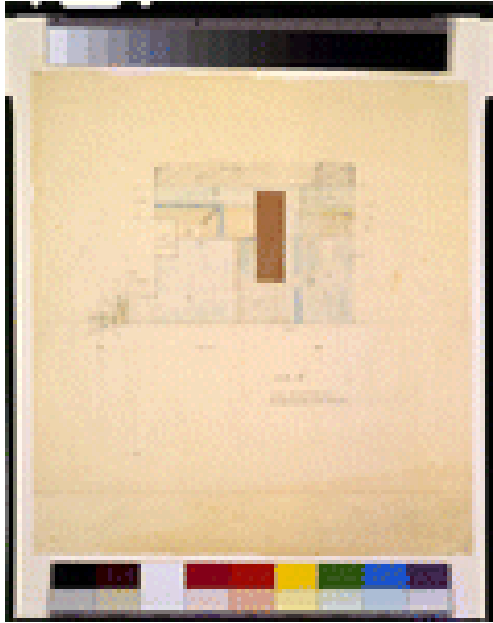

**TITLE:** [Hotel ("Imperial Hotel"), Tokyo, Japan.  
Unidentified design detail]

**CALL NUMBER:** ADE - UNIT 2956, no. 2 (B size)  
[P&P]

Check for an online group record (may link  
to related items)  
Original materials served by appointment  
only.

**REPRODUCTION NUMBER:** LC-USZC4-2203  
(color film copy transparency)  
LC-USZ62-106436 (b&w film copy neg.)

**RIGHTS INFORMATION:** Publication may be  
restricted. For information see "Frank Lloyd  
Wright"  
([http://lcweb.loc.gov/rr/print/res/259\\_wrig.html](http://lcweb.loc.gov/rr/print/res/259_wrig.html))

**MEDIUM:** 1 drawing : color pencil, graphite,  
and attached paper on Japanese paper.

**CREATED/PUBLISHED:** [between 1915 and  
1922]

**CREATOR:**

Wright, Frank Lloyd, 1867-1959, architect.

**NOTES:**

Inscription on recto: No. 5 / Size 6'4" x 10'4" /  
To be made two right.

Title devised by Library staff.

Forms part of: Visual materials from Donald  
D. Walker collection.

**FORMAT:**

Architectural drawings 1910-1930.

**REPOSITORY:** Library of Congress Prints and  
Photographs Division Washington, D.C.  
20540 USA

**DIGITAL ID:** (color film copy transparency)  
cph 3g02203  
<http://hdl.loc.gov/loc.pnp/cph.3g02203>  
(b&w film copy neg.) cph 3c06436  
<http://hdl.loc.gov/loc.pnp/cph.3c06436>

**CONTROL #:** 2002722727